



Security Engineered Machinery Co., Inc

OPERATIONAL & MAINTENANCE MANUAL

SEM Model 1121P Shredder

REV: 0



Security Engineered Machinery Co., Inc

NATIONWIDE SERVICE

Phone Toll Free 1(800)225-9293

Email: Service@SEMSHRED.COM

Fax: 1(508)366-6814

Table of Contents

READ CAREFULLY BEFORE USING

Proper care of your new paper shredder will ensure many years of trouble free operation, with minimum of maintenance or repair.

IMPORTANT: Please note that all packaging should be retained by the customer for (30) days from the time of receipt. In the event that this unit needs to be sent back for replacement or repair this packaging will be required to do so. Should the packaging have been discarded before the (30) day requested period, packaging costs will be incurred by the customer.

| <u>Contents</u> | <u>Page No.</u> |
|------------------------------|-----------------|
| Specifications..... | 2 |
| Safety Procedures..... | 3-4 |
| Installation and Set-up..... | 5 |
| Operation and Feeding | 6-7 |
| Maintenance & Cleaning..... | 8 |
| Possible Malfunctions..... | 9-11 |
| Accessories..... | 12 |
| Parts List | 13-16 |

Customer Service

Security Engineered Machinery Co., Inc.
PO Box 1045
5 Walkup Drive
Westboro, MA 01581

Tel: 800-225-9293

Fax: 508-366-6814

Website: www.semshred.com

E-mail: info@semshred.com

Order On-line:

GSA Customers: www.fedshred.com

Commercial Customers: www.semshred.com

IMPORTANT

Two to three preventive maintenance calls per year are recommended

For Nationwide Service call 1 (800)225-9293

Only authorized SEM service personnel should be allowed to service the shredder.

SPECIFICATIONS

| | |
|------------------|--------------------------|
| Shred Size | 1/8" x 1" |
| Sheet Capacity * | Up to 7 Sheets |
| Feed Opening | 8.75" |
| Bin Capacity | 5 Gallon |
| Dimensions | 13.5"W x 8.75"D x 17.8"H |
| Weight | 15 lbs. |

***Results may vary depending on power source, operator/proper maintenance and paper type.**

IMPORTANT SAFETY PROCEDURES



Please read these operating instructions before putting the machine into operation and observe the safety precautions. The operating instructions must always be available.



Children must not operate the machine!



Do not reach into the feed opening of the cutting head!



Long hair can become entangled in cutting head!



Take care of ties and other loose pieces of clothing.



Be careful of loose jewelry!

Safety Precautions

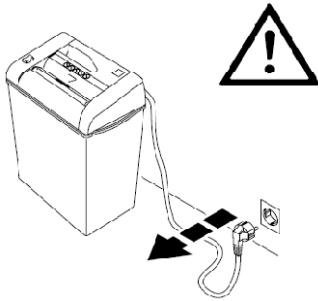

Remove the plug before cleaning the machine!

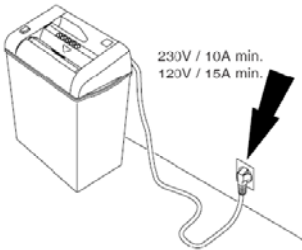

Ensure free access to mains!

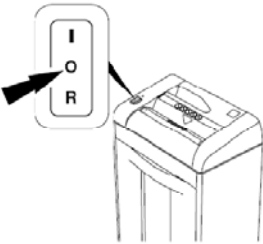

When not in use for a long time switch off!

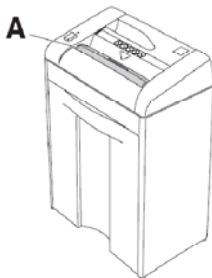

Do not operate the machine without the safety flap (A)

For Nationwide Service call 1 (800)225-9293

INSTALLATION

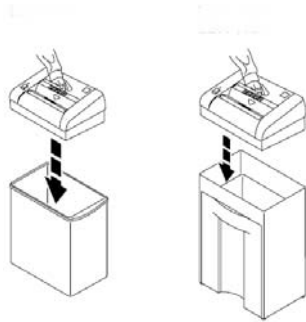

Place machine onto the shred bin or cabinet

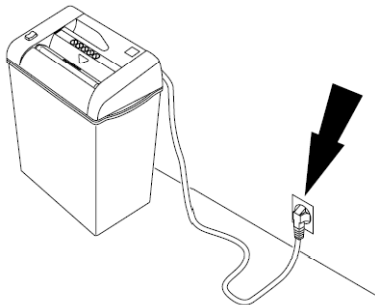

Plug into wall socket

For Nationwide Service call 1 (800)225-9293

OPERATION

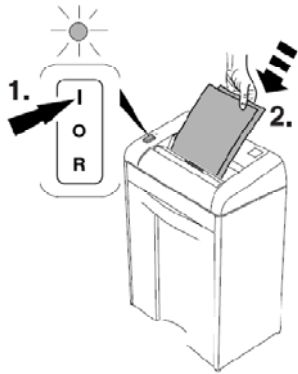

Turn the main switch to position “I”: The green control light will light **(1)**. Ready for operation. Starts automatically when paper is inserted **(2)**. Stops automatically when no further paper is inserted.

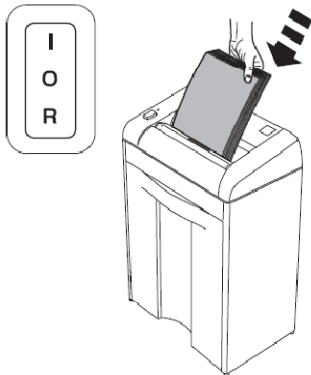

Stops automatically if too much paper is inserted.
(Machine blocks)

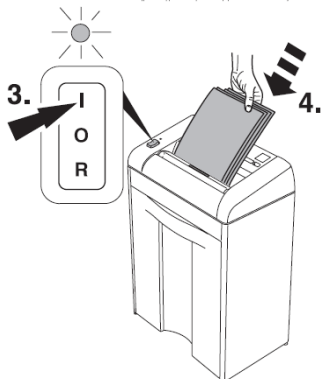
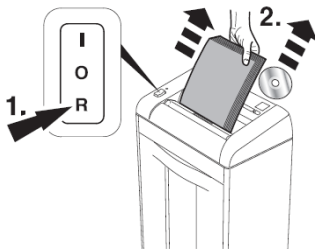

Press reverse button (1.) and remove paper (2.). Reset by pressing the rocker switch to position “I” (3.). Re-feed the paper in smaller quantities.

For Nationwide Service call 1 (800)225-9293

OPERATION Cont'd

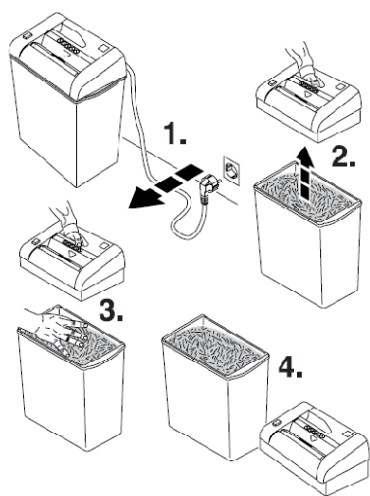

Empty the shred bin when it is full. (Level can be seen in the window **(A)**.)

MAINTENANCE AND CLEANING

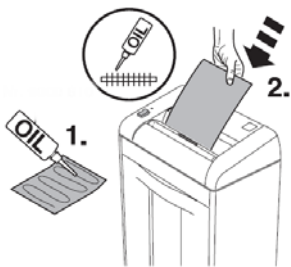

If the sheet capacity reduces or after the shred bin is emptied oil the shredding mechanism!
(See picture)

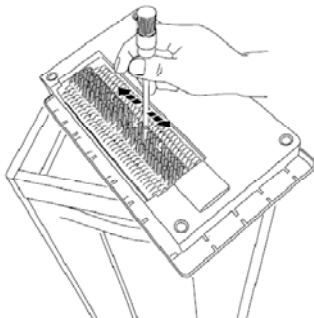

From time to time clean the output area of the cutting head.

- Disconnect from the mains.
- Remove paper debris with a brush.

*****DANGER OF INJURY*****

POSSIBLE MALFUNCTIONS

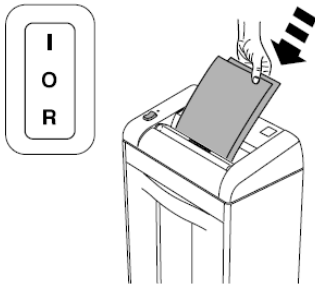

Machine will not start!

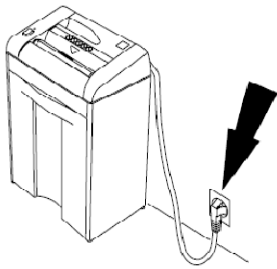

Is the machine plugged in?

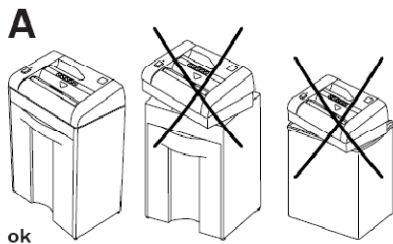

Machine is placed correctly on the shred bin or cabinet? (A) Shred bin is pushed in? (B)

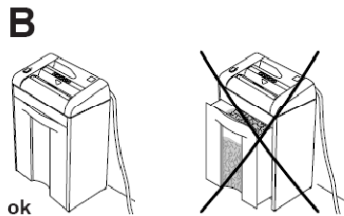

POSSIBLE MALFUNCTIONS Cont'd

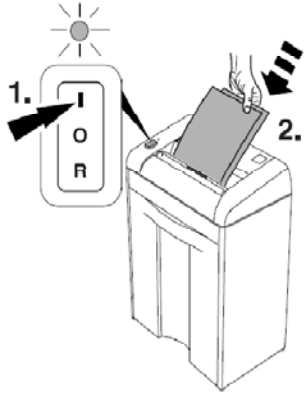

Is the switch in position “I”? Green LED lamp lights up? (1.) Insert paper (2.)

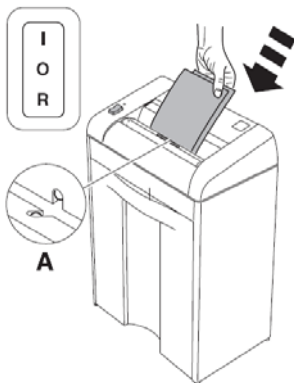

Feed the paper into the center of the feed opening? (photo cell) (A)

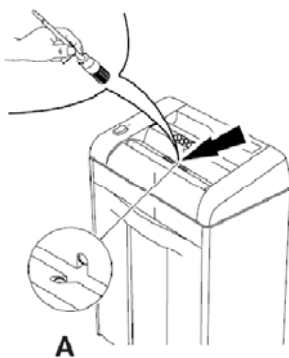

Machine will not stop.
Remove plug. Clean the photo cell (A) with a small brush.

POSSIBLE MALFUCTIONS Cont'd



Machine Stops.

Overload protection.

Cooling down period approx. 10-15 minutes



Empty the shred bins in sufficient time, at least daily, so that no interference is caused to the cutting head. If a paper jam, as described on page 10, cannot be corrected, because of an over filled shred bin, the shred bin must be emptied (see page 12)

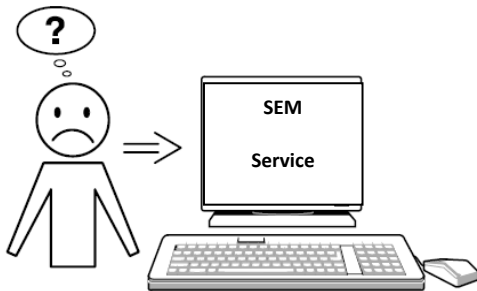

None of the above mentioned methods helped to solve the problem:

Contact our service team: 1 (800)225-9293

ACCESSORIES



Recommended accessories:
environmentally friendly oil (8 Pints)
Part # 649OIL8HV

CROSS / CUT 3x25mm

01.07.2007

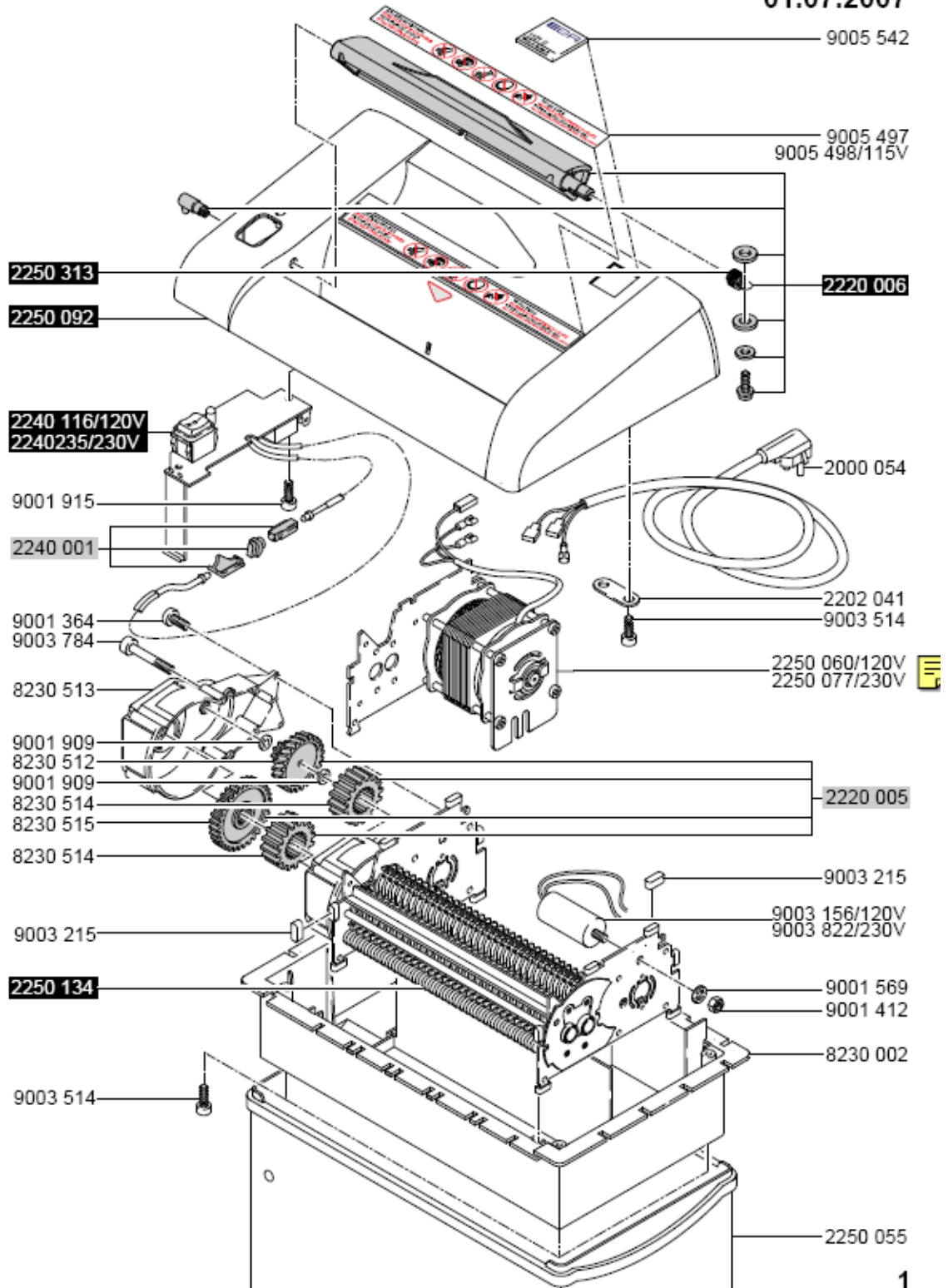

01.07.2007

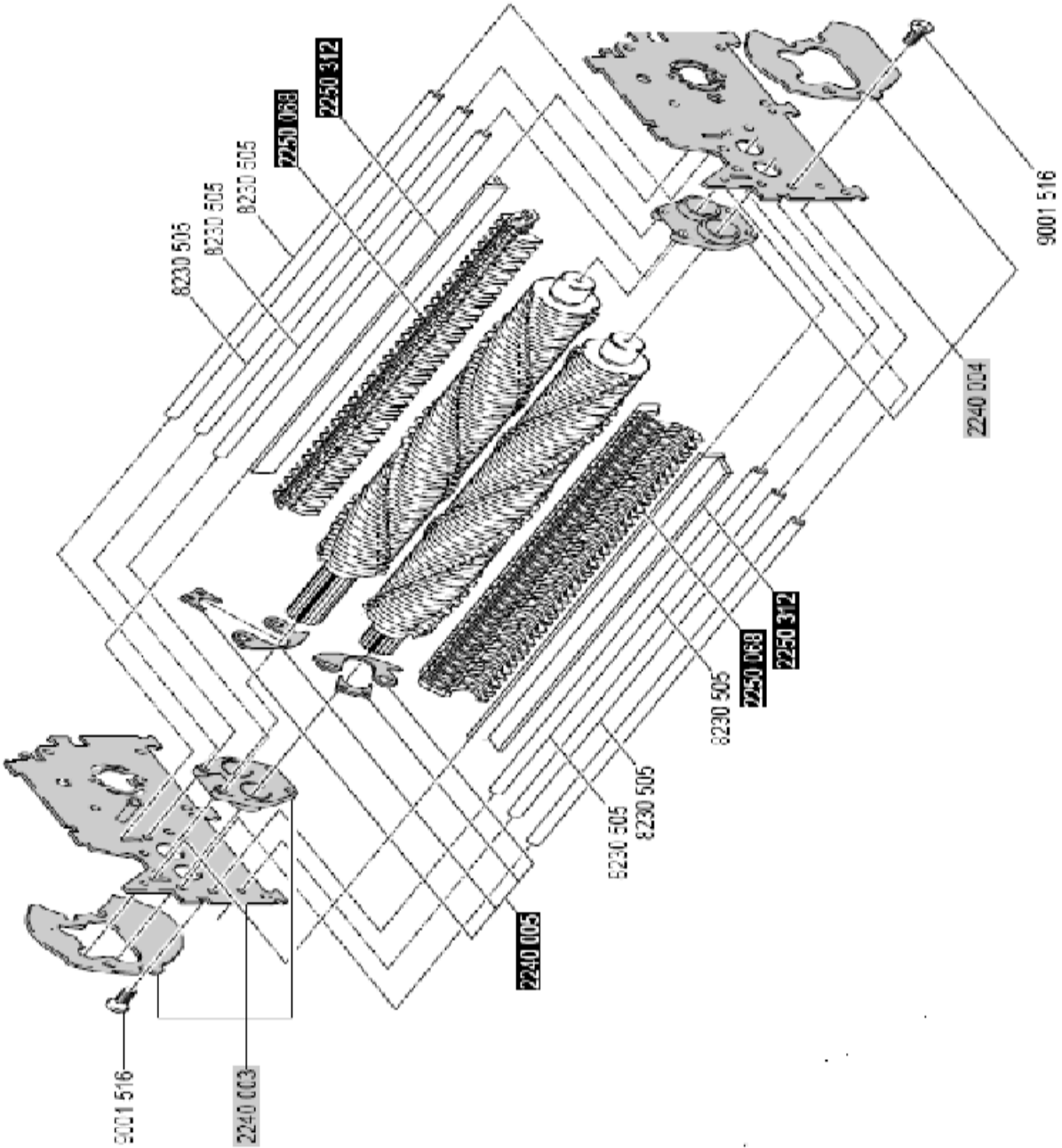

For Nationwide Service call 1 (800)225-9293

Mod. 1121 C D

01.07.2007

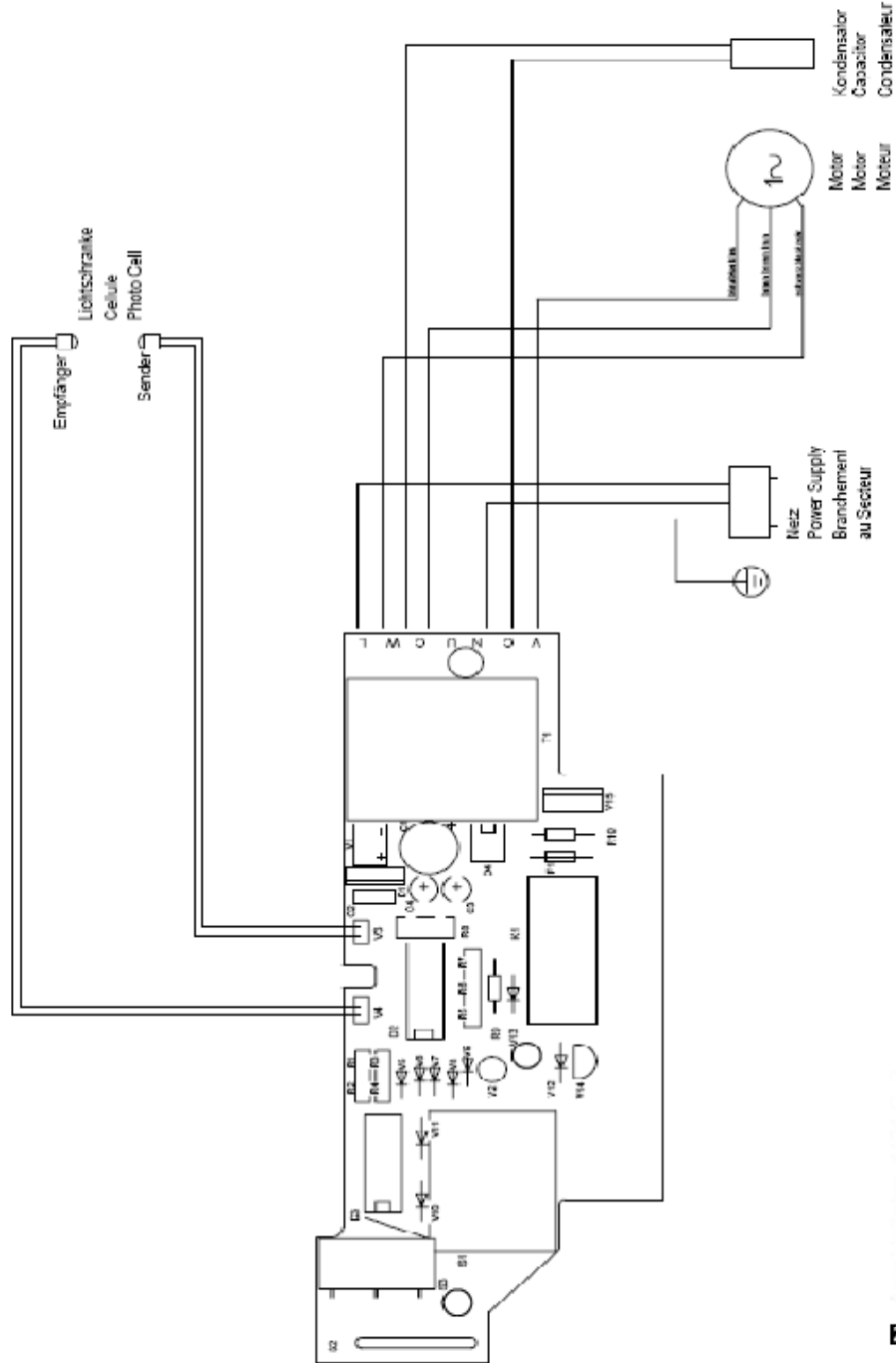

Connecting diagram 1121 C

2240 237

VIC 1191 C B

01.07.2007

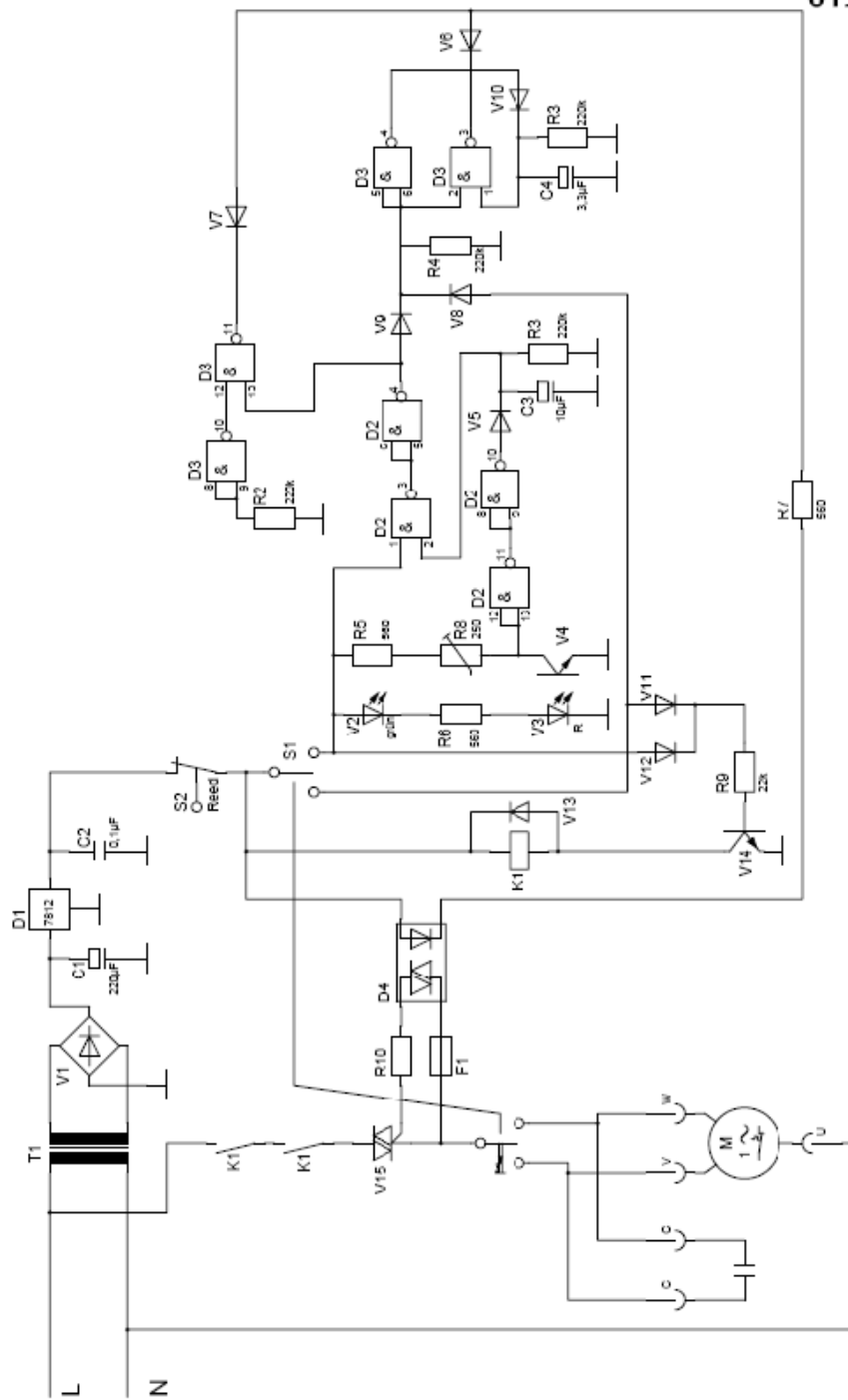

wiring diagram 1121

2240236



Security Engineered Machinery Co., Inc. Product Information



Paper Shredders, Disintegrators/Industrial Shredders

- Contract Number: GS-02F-0111P
- Contract Period: October 1, 2006 to September 30, 2011
- C3615 Shredders / Degaussers
- C3615 Accessories/Attachments for Shredders and Disintegrators
- C3615 Spare parts for Shredders and Disintegrators
- C3615 Disintegrators
- C3615 Remanufactured Disintegrators



Paper Shredders • Disintegrators • Security Containers • Optical Media Declassifiers

Shredding / Destruction Services

For detail product information including all application and specifications, contact our Customer Service Department at 1-800-225-9293 or visit us on line at www.semshred.com for commercial customers and www.fedshred.com for government customers.

For Nationwide Service call 1 (800)225-9293

For Nationwide Service call 1 (800)225-9293