



Security Engineered Machinery Co., Inc

## **OPERATIONAL & MAINTENANCE MANUAL**

### **SEM Model DX-DVDM DVD Disc Splitter**



Security Engineered Machinery Co., Inc.

#### **NATIONWIDE SERVICE**

Phone Toll Free: 1(800)225-9293

Email: [Service@SEMSHRED.com](mailto:Service@SEMSHRED.com)

Fax: 508-366-6814

Website: [WWW.SEMSHRED.COM](http://WWW.SEMSHRED.COM)

Rev. 0  
Created: 01/22/08

If you have already purchased the SEM Model DX-CD2, the Model DX-DVDm will now allow you the ability to destroy all DVD's on your Model DX-CD2 as well. Through the use of the DX-DVDm Splitter you will have the ability to split the DVD in half in order to remove all information from a DVD on the SEM Model DX-CD2 unit.

The following pages will explain in detail of how to use the DVD Splitter and how to use the Model DX-CD2 unit once your DVD's have been split in order to eliminate all data from these discs.

**Please Note:**

**In order to remove data stored on a DVD, these directions must be followed exclusively, and failure to split any DVD's prior to grinding in the Model DX-CD2 unit will result in data to be left on the DVD.**

**For NATIONWIDE SERVICE call 1(800)225-9293**

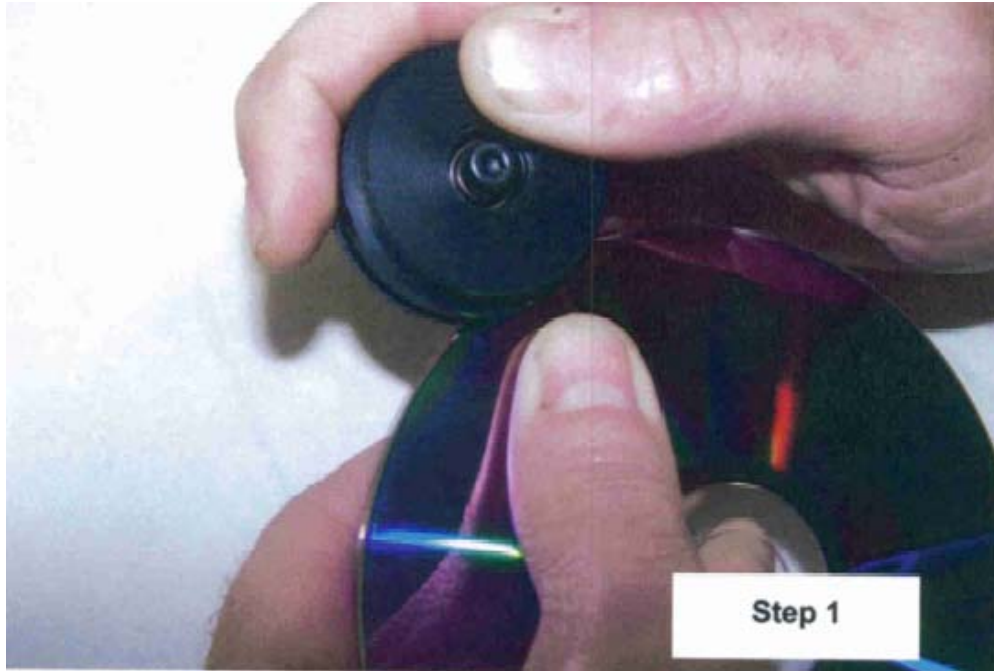

Grasp DVD disc firmly approximately ½ inch from the edge. Insert DVD disc into the groove of the DX-DVDm DVD Splitter as shown. Firmly press DVD disc into DX-DVDm until DVD disc layers are penetrated (The DX-DVDm may have to be rocked back and forth slightly to penetrate the DVD layers). The DX-DVDm will penetrate approximately ½ inch.

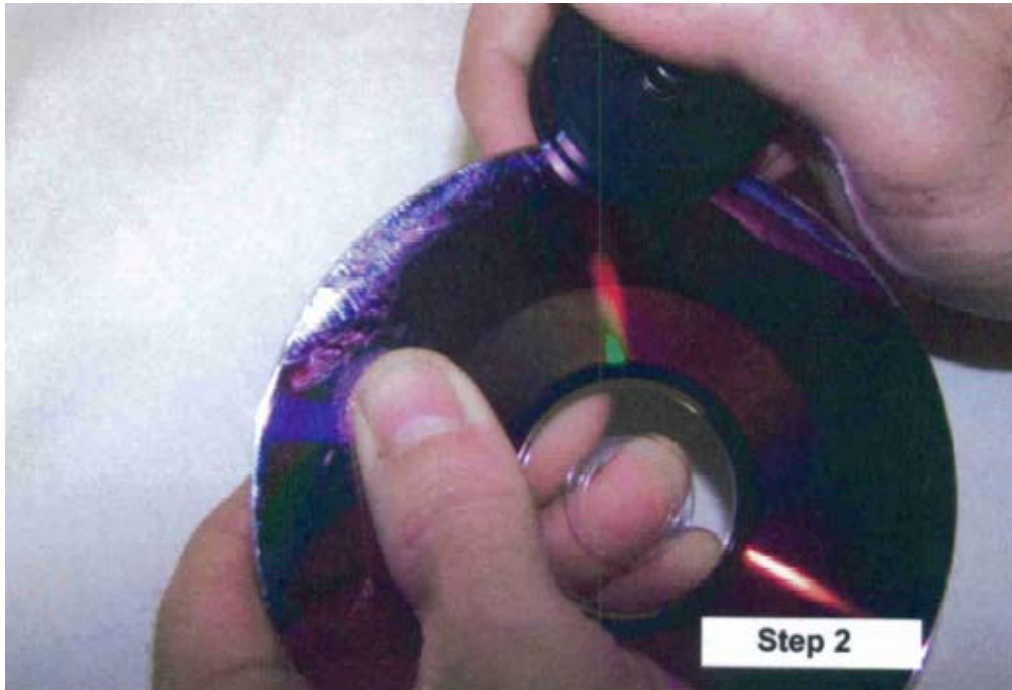

With the data layer facing the user (this allows a visual aid of the splitting process), carefully rotate the DX-DVDm completely around the circumference of the DVD disc as shown.

**For NATIONWIDE SERVICE call 1(800)225-9293**



Carefully work your fingers inward between the two pieces of plastic and rotate the disc until the two pieces are separated. Care should be taken not to crack or break either DVD disc layer.



Once DVD disc is split, the information layer(s) are exposed. Many times information can remain on both halves. Place the lower half of the DVD disc on top of the upper half. This renders the information layers to be on the outside.

**For NATIONWIDE SERVICE call 1(800)225-9293**



Place the DVD in the DX-CD2 and grind the DVD disc. Remove, flip over, and reinsert the DVD disc into the DX-CD2 and grind the DVD disc a second time.

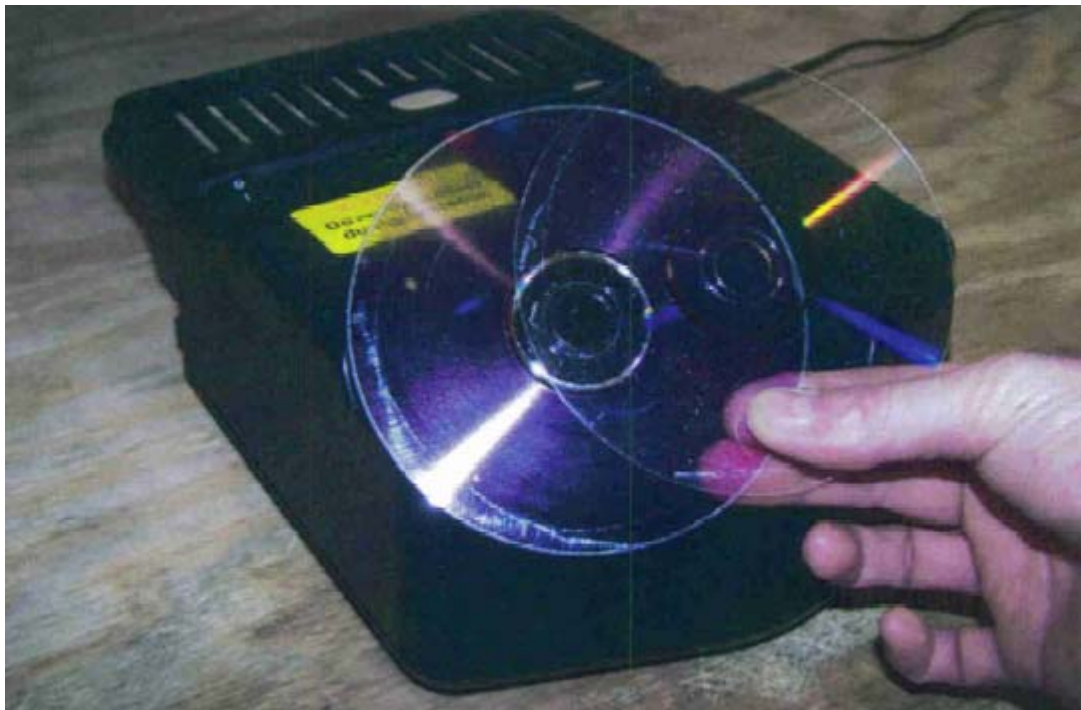

Data is now completely removed from the DVD disc.

**For NATIONWIDE SERVICE call 1(800)225-9293**



# Security Engineered Machinery Co., Inc. Product Information



## Paper Shredders, Disintegrators/Industrial Shredders

Contract Number: GS-02F-0111P  
 Contract Period: October 1, 2006 to September 30, 2011  
 C3615 Shredders  
 C3615 Accessories/Attachments for Shredders and Disintegrators  
 C3615 Spare Parts for Shredders and Disintegrators  
 C3615 Disintegrators  
 C3615 Remanufactured Disintegrators



## Information Technology

Contract Number: GS-35F-0297J  
 Contract Period: March 17, 1999 to March 15, 2009  
 132-8 Purchase of Equipment, FSC Class 7010, (IT)  
 132-12 Maintenance, Repair Service/Spare Parts, FPDS Code J070



## Recycling Collection Containers Specialty Waste Receptacle

### All types of Destruction Services

Open Market

Consult Factory

For detailed product information including all application and specifications, contact our Customer Service Department at 1-800-225-9293 or visit us on line at [www.semshred.com](http://www.semshred.com) for commercial customers and [www.fedshred.com](http://www.fedshred.com) for government customer.